



THREE PASS FIRETUBE HOT WATER BOILER

■ HURST “PERFORMANCE” BOILERS ■

LPW SERIES

THROUGH THE DOOR DESIGN!

Hot Water Applications



- Specifiable using the attributes of the LPE design.
- Remains classified as a modified scotch, firetube type boiler.
- Efficiencies tested at >83% on natural gas.
- Smaller foot print, can be installed in tighter places.
- Semi wet-back construction.

Capacities From

30 to 125 HP

30 PSI Water

[60 PSI Water Optional]

UL Approved Forced Draft Burners

HEAVIEST DESIGNED BOILER IN ITS CLASS

Designed, constructed and stamped in accordance with the requirements of the ASME Boiler Codes.



Inspected and registered with the National Board of Boiler & Pressure Vessel Inspectors.

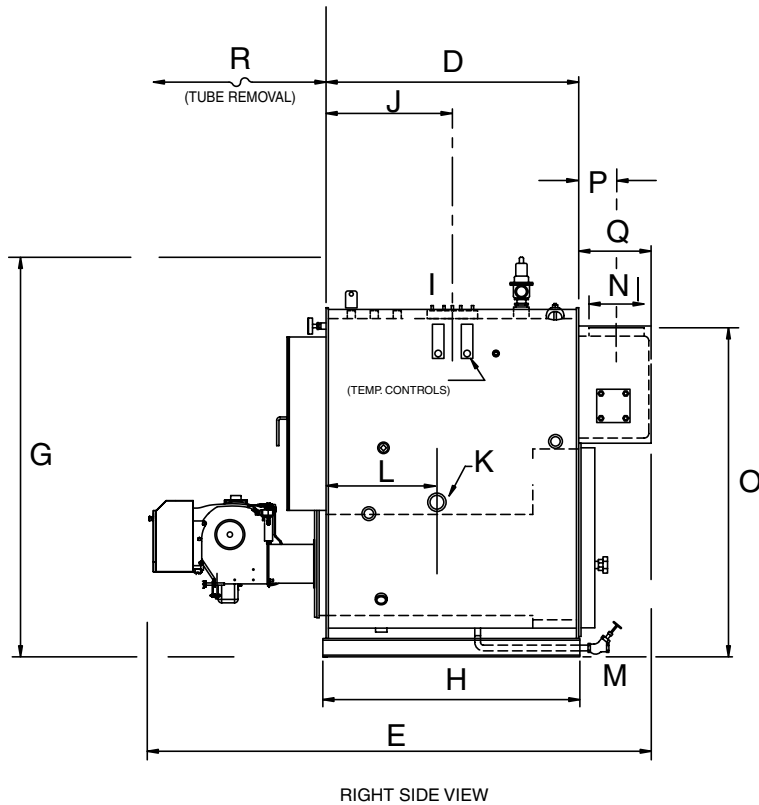
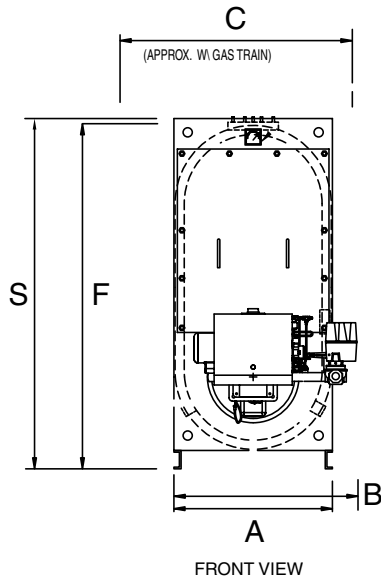

**BOILER SPECIFICATIONS
(ALL DIMENSIONS ARE IN INCHES)**

DIMENSIONS SUBJECT TO CHANGE WITHOUT NOTICE. CERTIFIED DRAWINGS AVAILABLE UPON REQUEST.

BOILER HORSEPOWER			30	40	50	60	70	80	100	125	
HEATING SURFACE	FIRESIDE	SQ.FT.	120	160	200	235	284	338	418	511	
MBH OUTPUT, HOT WATER			1004	1339	1674	2009	2343	2678	3348	4184	
FIRING RATE, GAS	1,000 BTU	CFH	1260	1680	2100	2520	2940	3360	4200	5250	
FIRING RATE, #2 OIL	140,000 BTU	GPH	9	12	15	18	21	24	30	37.4	
A WIDTH WITHOUT TRIM		IN	31	31	31	34 1/2	34 1/2	34 1/2	34 1/2	34 1/2	A
B WIDTH WITH TRIM		IN	38	38	38	42	42	42	42	42	B
C WIDTH WITH GAS TRAIN		IN	49	49	49	52	52	52	52	52	C
D BOILER LENGTH		IN	37	49	61	55	67	79	91	106	D
E OVERALL LENGTH	STD. BURNER	IN	86	98	114	111	123	140	152	169	E
F SUPPLY HEIGHT		IN	71 1/2	71 1/2	71 1/2	76 5/8	76 5/8	76 5/8	76 5/8	76 5/8	F
G HEIGHT WITH TRIM		IN	80	80	83	88	88	88	93	93	G
H LENGTH OF SKID		IN	37 1/2	49 1/2	61 1/2	55 1/2	67 1/2	79 1/2	91 1/2	106 1/2	H
I SUPPLY SIZE		IN	4	4	4	6	6	6	6	6	I
J SUPPLY LOCATION		IN	18 1/2	24 1/2	30 1/2	27 1/2	33 1/2	39 1/2	45 1/2	50 1/2	J
K RETURN SIZE		IN	4	4	4	4	4	4	4	4	K
L RETURN LOCATION		IN	27 1/4	27 1/4	27 1/4	32	32	32	32	36	L
M BOILER DRAIN SIZE		IN	1	1 1/4	1 1/4	1 1/4	1 1/2	1 1/2	1 1/2	1 1/2	M
N STACK DIAMETER, O.D.		IN	10	10	10	12	12	12	12	14	N
O STACK HEIGHT		IN	66 3/4	66 3/4	66 3/4	70 1/4	70 1/4	70 1/4	70 1/4	72	O
P TO CENTER OF STACK		IN	6 7/8	6 7/8	6 7/8	8 1/4	8 1/4	8 1/4	8 1/4	9 1/4	P
Q REAR SMOKEBOX DEPTH		IN	13 3/4	13 3/4	13 3/4	15 3/4	15 3/4	15 3/4	15 3/4	17 3/4	Q
R TUBE PULL SPACE		IN	38	50	62	56	68	80	92	107	R
S OVERALL HEIGHT		IN	72	72	72	78 1/2	78 1/2	78 1/2	78 1/2	78 1/2	S
SHIPPING WEIGHT		LBS	3050	3800	4500	4500	5285	6100	6950	8010	
WATER CONTENT - WATER	FLOODED	GALS	134	180	232	243	298	376	404	463	
BOILER HORSEPOWER			30	40	50	60	70	80	100	125	

CONNECTIONS FOUR INCHES AND SMALLER ARE FEMALE THREAD, 6" CONNECTIONS ARE 150 LB. FLANGES. * STUDDING FLANGE.

THREE PASS FIRETUBE HOT WATER BOILER

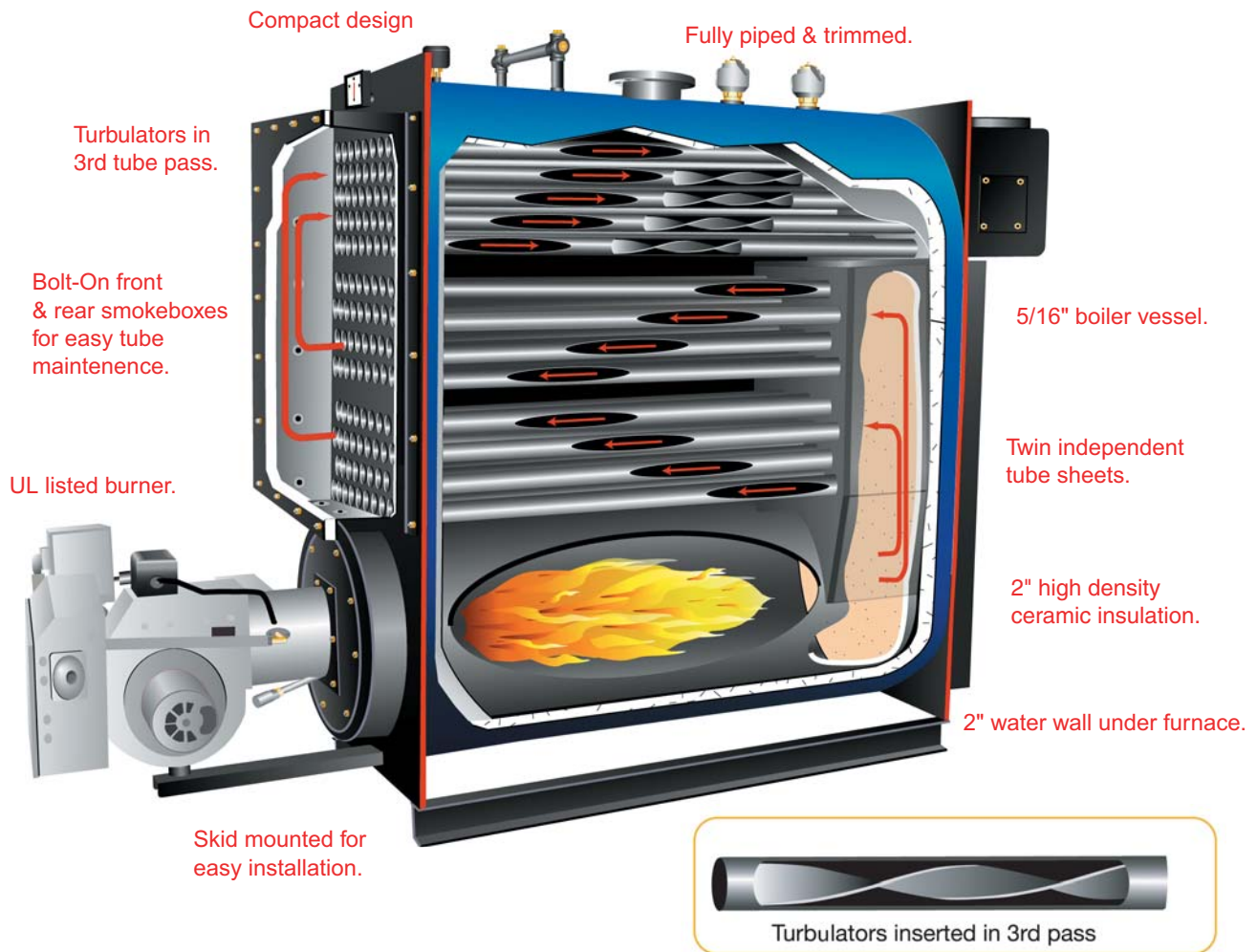

STANDARD EQUIPMENT

BOILER: Three pass design for 30 psi hot water (available for 60 psi water). Factory assembled with trim and, tested in accordance with ASME code, UL, and CSD-1 codes. Steel turbulators inserted in third pass for maximum heat-transfer control.

STANDARD BOILER TRIM: Kunkle safety relief valve, operating temperature control, high limit temperature control with manual reset, 3 1/2" combination pressure & temperature gauge, M&M 750 low water cut-off control with manual reset.

BURNER: UL listed with pre-piped, wired and factory tested forced draft power burners for:

- Natural Gas
- Propane (LP) Gas
- No. 2 (Diesel) Oil
- Combination Gas/Oil

■ **HURST “PERFORMANCE” BOILER** ■

- Factory Assembled, Prewired and Tested.
- No Field Assembly Required.
- UL Listed Boiler/Burner Packages.
- Fully Assembled, Pre-piped, Prewired, Pressure Tested Gas Trains.
- Complies with ASME, UL, CSD-1 and ASHRAE Standards.
- High Efficiency, Low Stack Temperatures.
- Customer Service Support Through National Network of Sales, Service, St Training and Parts by Factory Representatives.

LPW BOILER FEATURES

Modified Scotch designed to fit through a standard 36” x 80” door opening
Up to 125 HP (4,184 mbh output).

The Hurst LPW “Performance” boiler is America’s most heavily designed and built boiler in its class. Consider the features and specify the Hurst LPW Series.

1. A welded steel firetube boiler, the LPW has extra-heavy 13-gauge tubes for extended life. All tubes are attached to the tube sheets by rolling and flaring. There are no welded tubes in the LPW.
2. Thickest materials used in the industry.
 - A. Boiler shell is 5/16” thick boiler plate 30-40 HP / 3/8” 50-125 HP.
 - B. Twin boiler tube sheets are 1/2” thick boiler plate.
 - C. Insulation is 2” ceramic wool and is lagged with 22-gauge boiler jacket.
 - D. Extra heavy 4” channel iron boiler skids.
3. Designed to last with special industrial grade features.
 - A. Couplings are 3,000 psi.
 - B. Flanged, detachable front and rear smoke boxes.
 - C. Brass nuts on front access panels, brass plugs in factory pre-piped crosses and tees on trim.

Revised 11/05

hurstboiler.com



P. O. Drawer 530
21971 Highway 319 N.
Coolidge, Georgia 31738-0530
Tel: (229) 346-3545
Fax: (229) 346-3874
e-mail: info@hurstboiler.com